

Fixed castor CDF 200 EB

Transport Series CD - Wheel E

 -20 °C - +70 °C

 **swivels easily**

 **wear resistant**

 **shock proof**

 **floor protective**

 **weather proof**

Wheel



Tread: Elastic solid rubber tyre, black, 73±5 Shore A, vulcanised on wheel centre

Wheel centre: Die-cast aluminium alloy

Fork



Finish: electro-zinc plated, double ball bearing – revited, hardened steel balls thermoplastic dust protection ring, wheel axle bolted, total lock

Fixed castor	Wheel-Ø A x width B mm: 200x50
Load Capacity kg:	300
Load capacity tested according to EN 12530 and EN 12527	
Overall height H mm:	240
Dimension of top plate TP mm:	135x110
Hole spacing HS mm:	105x80
Hole-Ø HD mm:	11
Wheel bearing:	Roller bearing

Advantages

- ✓ excellent running performance
- ✓ very silent in motion
- ✓ low rolling resistance
- ✓ good abrasion resistance
- ✓ corrosion resistant
- ✓ non-marking in grey

©Copyright 2024 Rollenbau GmbH, www.rollenbau.at 20.05.2024

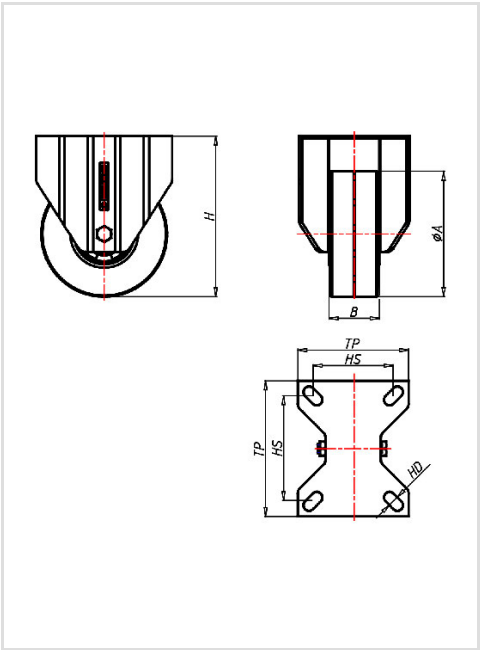

Applications

- Bins
- Refuse bins
- Dollies
- Trash containers
- Refuse containers